

MAP 5 - PROPOSED SITE PLAN

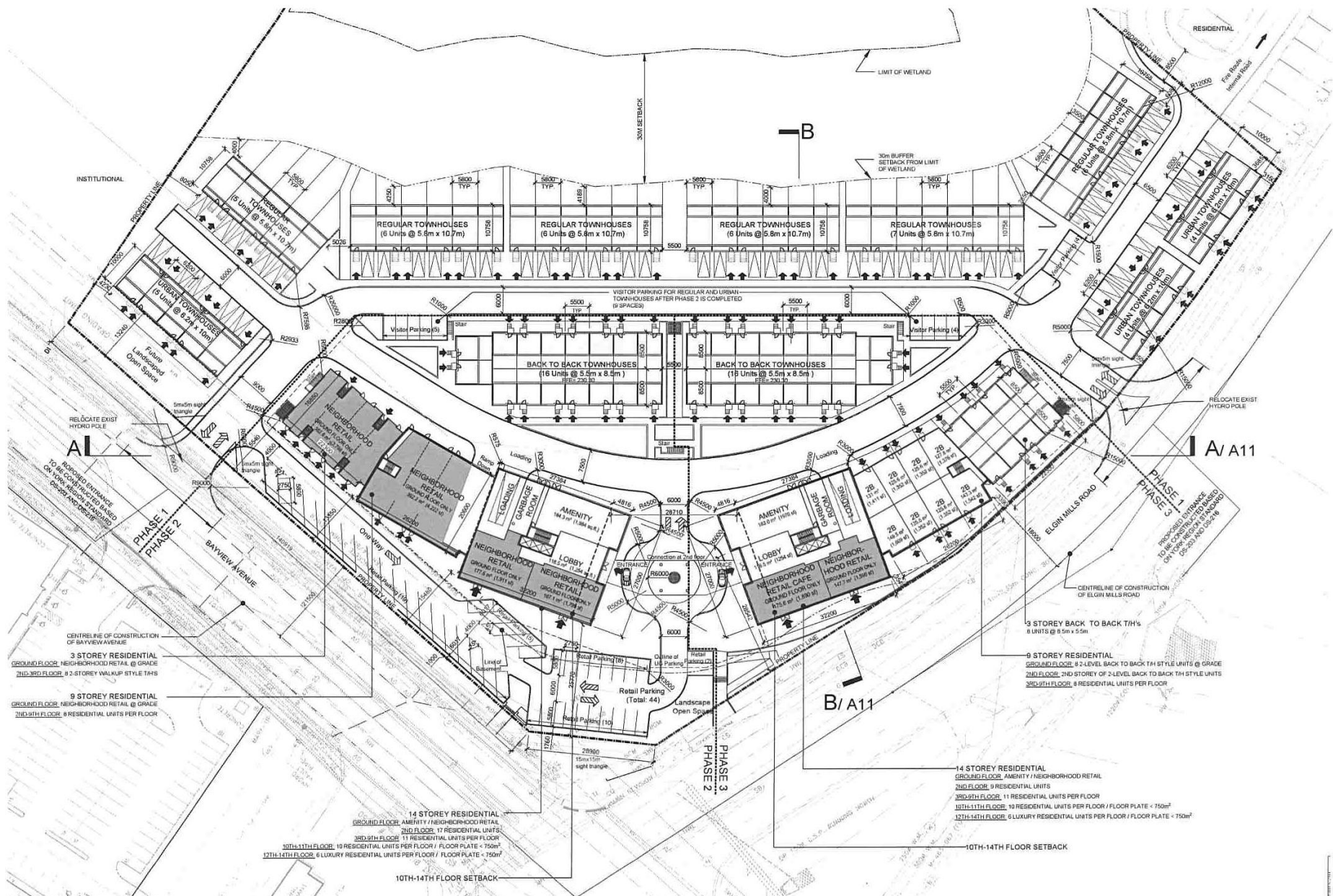

3 STOREY RESIDENTIAL
GROUND FLOOR: NEIGHBORHOOD RETAIL @ GRADE
2ND-3RD FLOOR: 3 STOREY WALKUP STYLE T4HS

9 STOREY RESIDENTIAL
GROUND FLOOR: NEIGHBORHOOD RETAIL @ GRADE
2ND-10TH FLOOR: 8 RESIDENTIAL UNITS PER FLOOR

14 STOREY RESIDENTIAL
GROUND FLOOR: AMENITY / NEIGHBORHOOD RETAIL
2ND FLOOR: 17 RESIDENTIAL UNITS
3RD-11TH FLOOR: 11 RESIDENTIAL UNITS PER FLOOR
10TH-11TH FLOOR: 10 RESIDENTIAL UNITS PER FLOOR / FLOOR PLATE < 750m²
12TH-14TH FLOOR: 6 LUXURY RESIDENTIAL UNITS PER FLOOR / FLOOR PLATE < 750m²

3 STOREY BACK TO BACK T/H's
8 UNITS @ 8.5m x 5.5m

9 STOREY RESIDENTIAL
GROUND FLOOR: 3-LEVEL BACK TO BACK T4H STYLE UNITS @ GRADE
2ND-10TH FLOOR: 2ND STOREY OF 2-LEVEL BACK TO BACK T4H STYLE UNITS
3RD-10TH FLOOR: 8 RESIDENTIAL UNITS PER FLOOR

14 STOREY RESIDENTIAL
GROUND FLOOR: AMENITY / NEIGHBORHOOD RETAIL
2ND FLOOR: 9 RESIDENTIAL UNITS
3RD-11TH FLOOR: 11 RESIDENTIAL UNITS PER FLOOR
10TH-11TH FLOOR: 10 RESIDENTIAL UNITS PER FLOOR / FLOOR PLATE < 750m²
12TH-14TH FLOOR: 6 LUXURY RESIDENTIAL UNITS PER FLOOR / FLOOR PLATE < 750m²

BLOCK 14

FILE Nos. D01-18008
D02-16036

**CITY OF RICHMOND HILL
PLANNING AND REGULATORY
SERVICES DEPARTMENT**