

MAP 9 - Elm Grove / Maple Grove / Aubrey Avenue Residential Infill Study

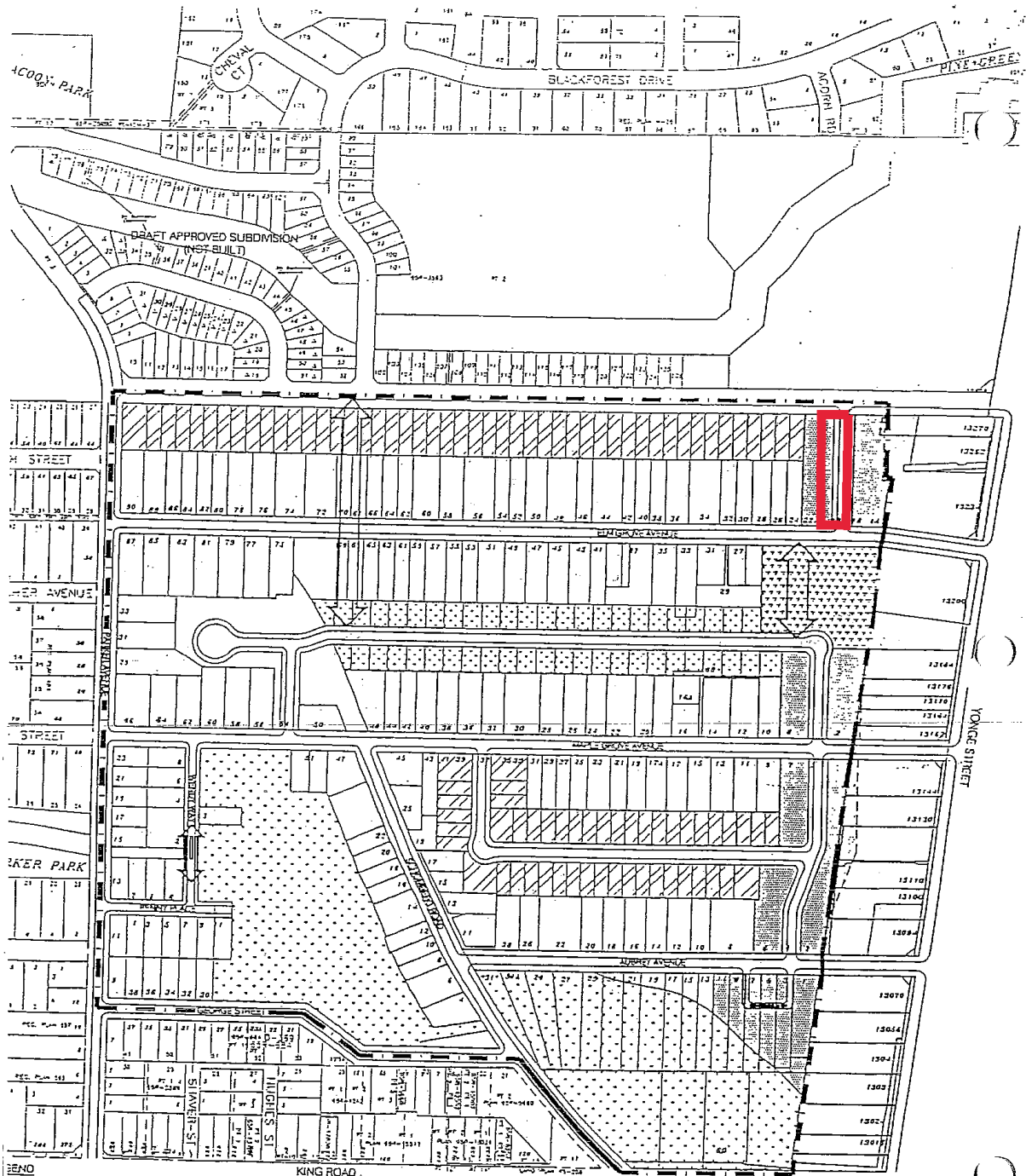

- STUDY AREA
- PROPOSED PARK
- PROPOSED INFILL SINGLE FAMILY RESIDENTIAL 45' LOTS
- RESURFACING LOTS SINGLE FAMILY RESIDENTIAL 60' WIDE SHALLOW LOTS
- PROPOSED MEDIUM DENSITY RESIDENTIAL INFILL
- CONSERVATION LAND

OPA 129
 Town of Richmond Hill
 ELM GROVE/ MAPLE GROVE/ AUBREY RESIDENTIAL INFILL STUDY
 UD+D
 Map 2

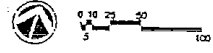

SUBJECT LAND

KG/SS SRPRS.19.152

**FILE Nos. D02-19011
BLOCK NO.01 D03-19003**

**City of Richmond Hill
Planning and Regulatory
Services Department**