

MAP 4 - PROPOSED SITE PLAN

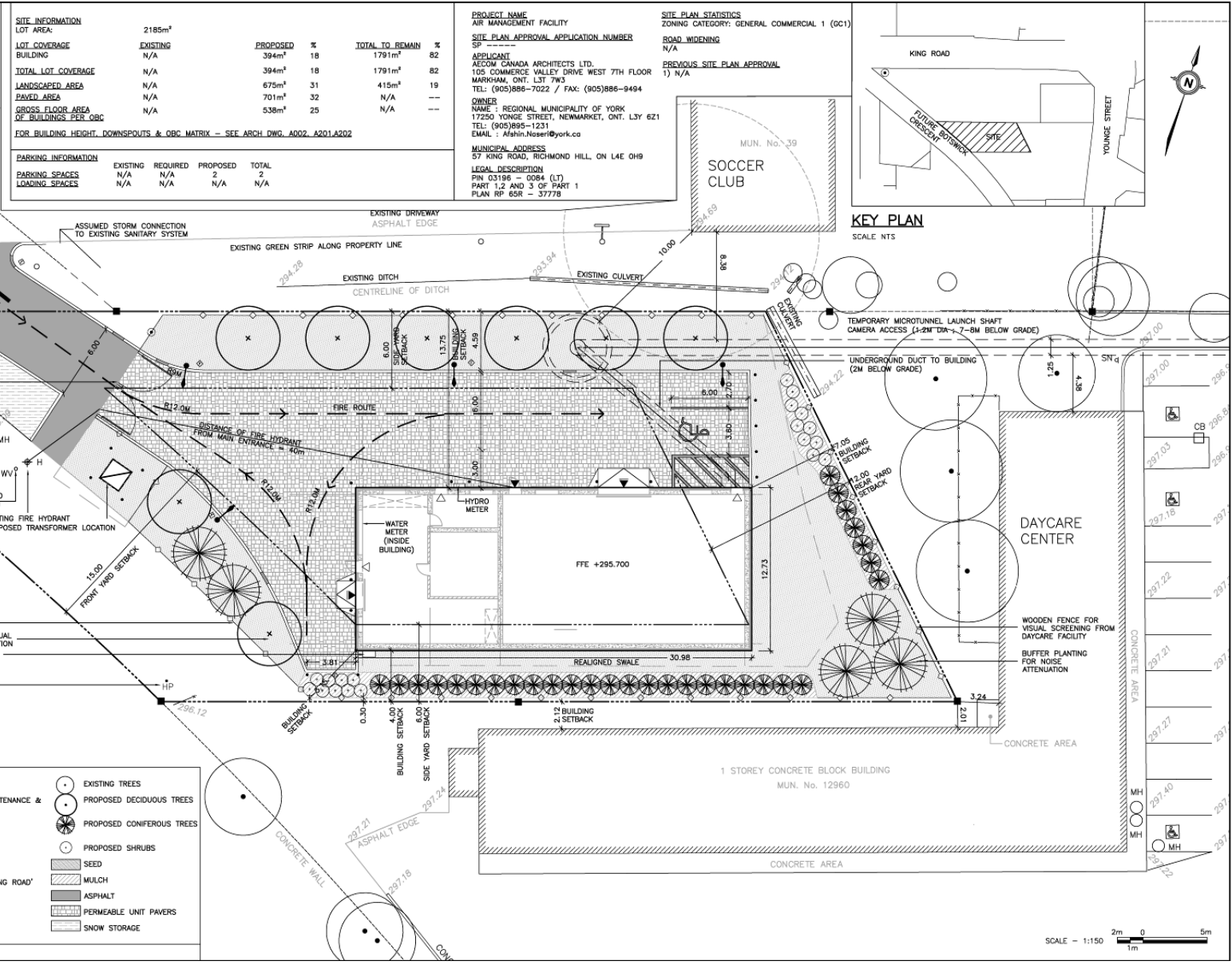

SITE INFORMATION					
LOT AREA		2185m ²			
LOT COVERAGE	EXISTING		PROPOSED	%	TOTAL TO REMAIN
BUILDING	N/A		394m ²	18	1791m ²
TOTAL LOT COVERAGE	N/A		394m ²	18	1791m ²
LANDSCAPED AREA	N/A		675m ²	31	415m ²
PAVED AREA	N/A		701m ²	32	N/A
GROSS FLOOR AREA OF BUILDINGS PER OBC	N/A		538m ²	25	N/A

FOR BUILDING HEIGHT, DOWNSPOUTS & OBC MATRIX - SEE ARCH. DWG. A002_A201A202

PARKING INFORMATION					
PARKING SPACES	EXISTING	REQUIRED	PROPOSED	TOTAL	
	N/A	N/A	2	2	
LOADING SPACES	N/A	N/A	N/A	N/A	

PROJECT NAME
AIR MANAGEMENT FACILITY

SITE PLAN APPROVAL APPLICATION NUMBER
SP -

APPLICANT
AECOM CANADA ARCHITECTS LTD.
105 COMMERCE VALLEY DRIVE WEST 7TH FLOOR
MARKHAM, ONT. L3T 7W5
TEL: (905)886-7022 / FAX: (905)886-9494

OWNER
NAME: REGIONAL MUNICIPALITY OF YORK
17250 YONGE STREET, NEWMARKET, ONT. L3Y 6Z1
TEL: (905)895-1231
EMAIL: Afahin.Noseri@york.ca

MUNICIPAL ADDRESS
57 KING ROAD, RICHMOND HILL, ON L4E 0H9

LEGAL DESCRIPTION
PIN 03196 - 0084 (LT)
PART 1,2 AND 3 OF PART 1
PLAN RP 65R - 37778

SITE PLAN STATISTICS
ZONING CATEGORY: GENERAL COMMERCIAL 1 (GC1)
ROAD WIDENING
N/A
PREVIOUS SITE PLAN APPROVAL
1) N/A

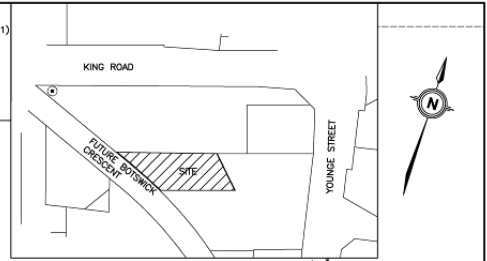

LEGEND

--- PROPERTY LINE/ LIMIT OF WORK	▲ PRINCIPAL ENTRANCE	○ EXISTING TREES
◆ PROPERTY SETBACKS	▲ ROLL UP DOOR (MAINTENANCE & EQUIPMENT ACCESS)	○ PROPOSED DECIDUOUS TREES
- FIRE ROUTE SIGN POST	▽ EXIT	○ PROPOSED CONIFEROUS TREES
H+ EXISTING FIRE HYDRANT	● LIGHT POLES	○ PROPOSED SHRUBS
HP EXISTING HYDRO POLE	● BOLLARDS	○ SEED
◇ WOODEN FENCE (1.8M HT)	○ PROPOSED SIGNAGE "YORK REGION, 57 KING ROAD"	○ MULCH
— BARRIER CURB	— CURB CUT	○ ASPHALT
		○ PERMEABLE UNIT PAVERS
		○ SNOW STORAGE

NOTES:

- ENTIRE SITE FALLS WITHIN TRCA BOUNDARY LIMITS
- PROPOSED LOCATION OF TRANSFORMER TO BE CONFIRMED
- ADDITIONAL PROPERTY SIGNAGE PROPOSED ON FENCE

SCALE - 1:150
2m 0 5m
1m

BLOCK 08 File No. D06-20013

**CITY OF RICHMOND HILL
PLANNING AND REGULATORY
SERVICES DEPARTMENT**