

MAP 3 - ELM GROVE/MAPLE GROVE/AUBREY AVENUE RESIDENTIAL INFILL STUDY

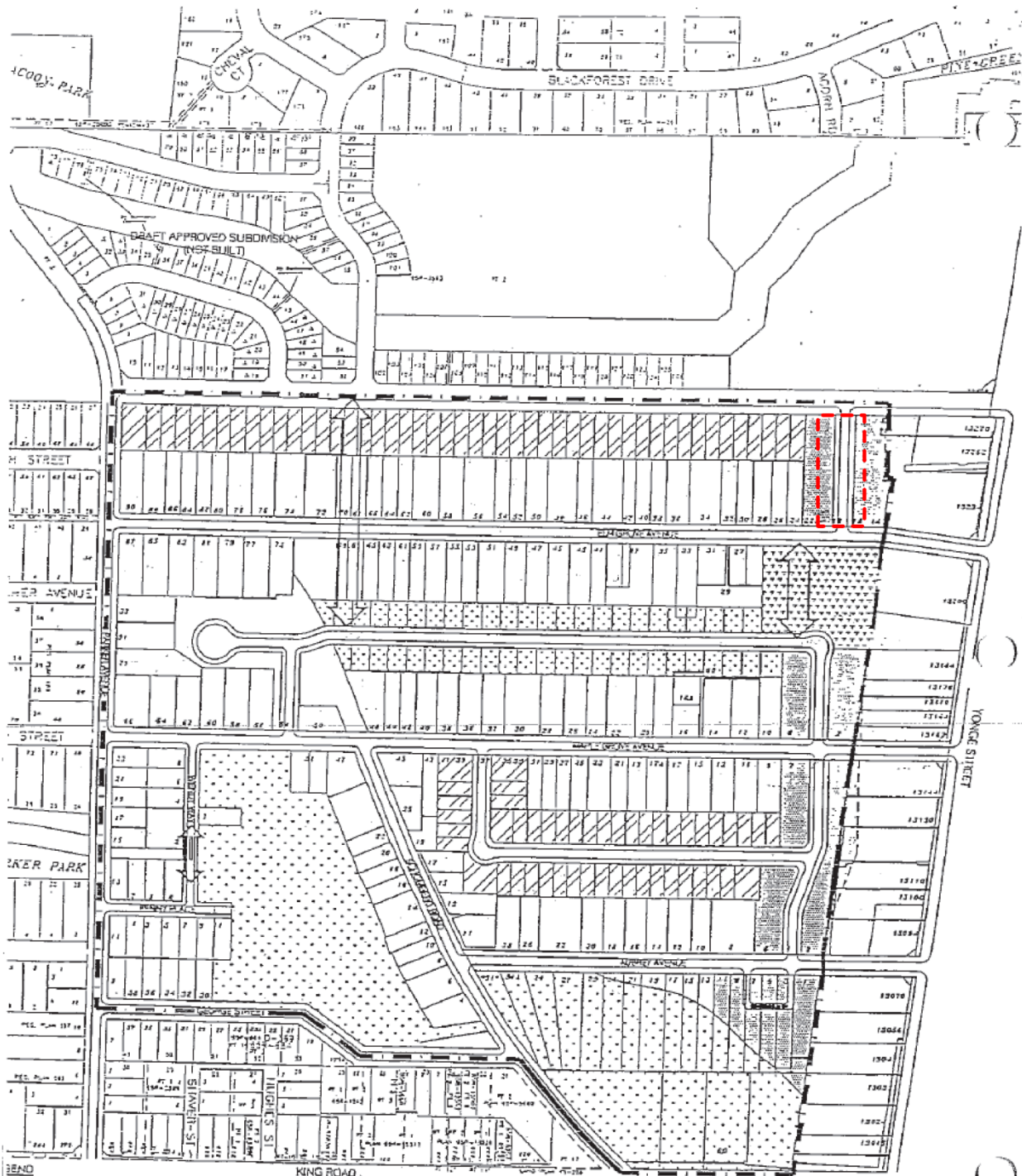

- STUDY AREA
- PROPOSED PARK
- PROPOSED INFILL SINGLE FAMILY RESIDENTIAL 45' LOTS
- PROPOSED REMAINS LOT SINGLE FAMILY RESIDENTIAL 60' WIDE SHALLOW LOTS
- PROPOSED MEDIUM DENSITY RESIDENTIAL INFILL
- CONSERVATION LAND

OPA 129
 Town of Richmond Hill
 ELM GROVE/ MAPLE GROVE/ AUBREY RESIDENTIAL INFILL STUDY

UD+D
 URBAN DESIGN

Map 2

18 Elm Grove Avenue

BLOCK 01 D02-19011 and D03-19003

LEGEND
 SUBJECT LANDS

SF/VC SRPI.22.105

**CITY OF RICHMOND HILL
 PLANNING AND INFRASTRUCTURE
 DEPARTMENT**

Path: \\richmondhill.local\divisions\11\GIS\11\Logs and Metrics\Requests\2022\20220810_SF_ILR011_002-19011_D03-19003_SRPI.22.105_100x100\loss\Staffreport_Map\Staffreport_map.aprx