

THE PREFERRED CONCEPT PLAN

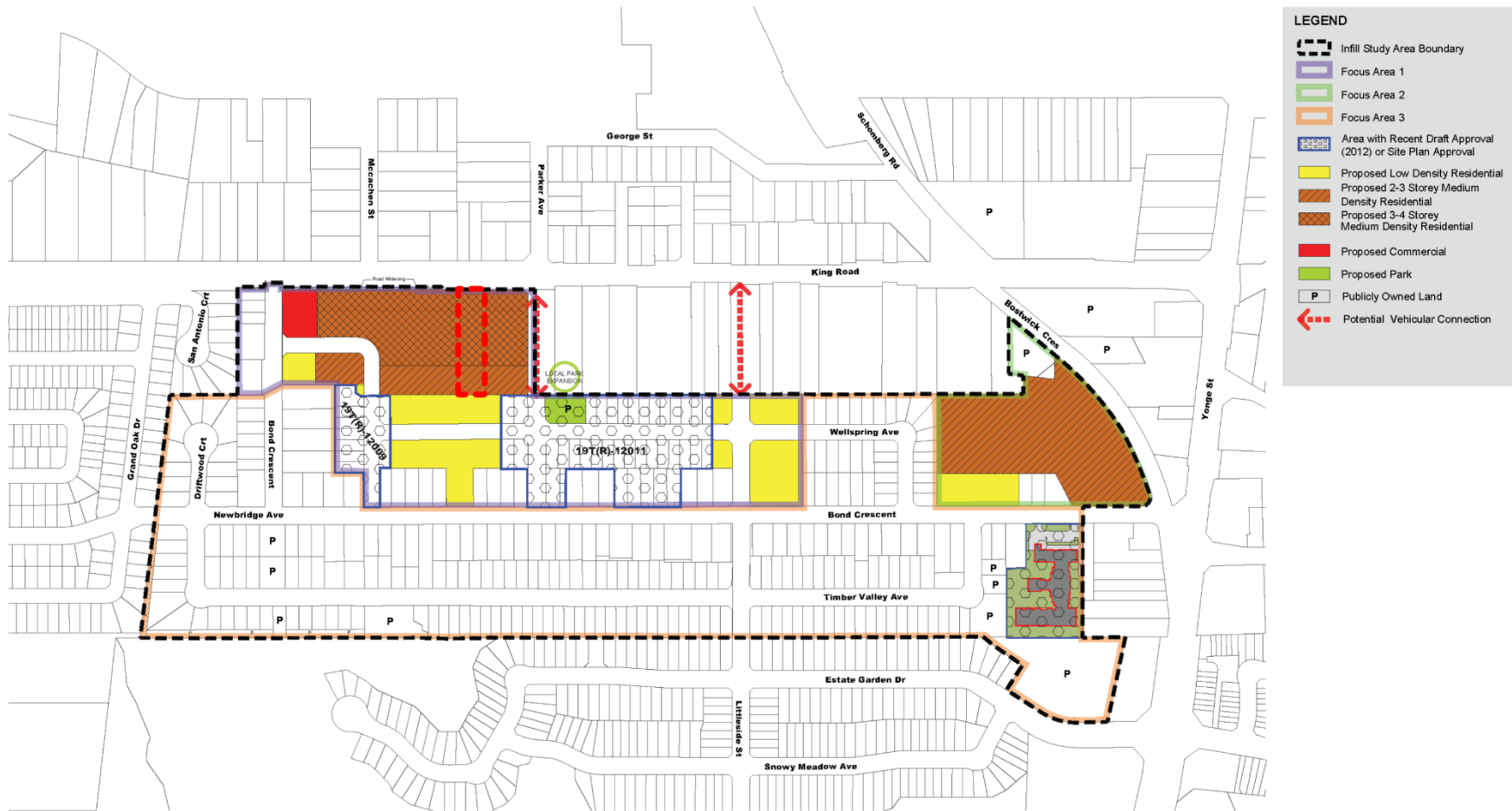

LEGEND

- Infill Study Area Boundary
- Focus Area 1
- Focus Area 2
- Focus Area 3
- Area with Recent Draft Approval (2012) or Site Plan Approval
- Proposed Low Density Residential
- Proposed 2-3 Storey Medium Density Residential
- Proposed 3-4 Storey Medium Density Residential
- Proposed Commercial
- Proposed Park
- Publicly Owned Land
- Potential Vehicular Connection

295 King Road

LP/SD SRPI.23.071

BLOCK 8 File NO. D02-21013

**CITY OF RICHMOND HILL
PLANNING AND INFRASTRUCTURE
DEPARTMENT**