

MAP 3 - EXISTING ZONING

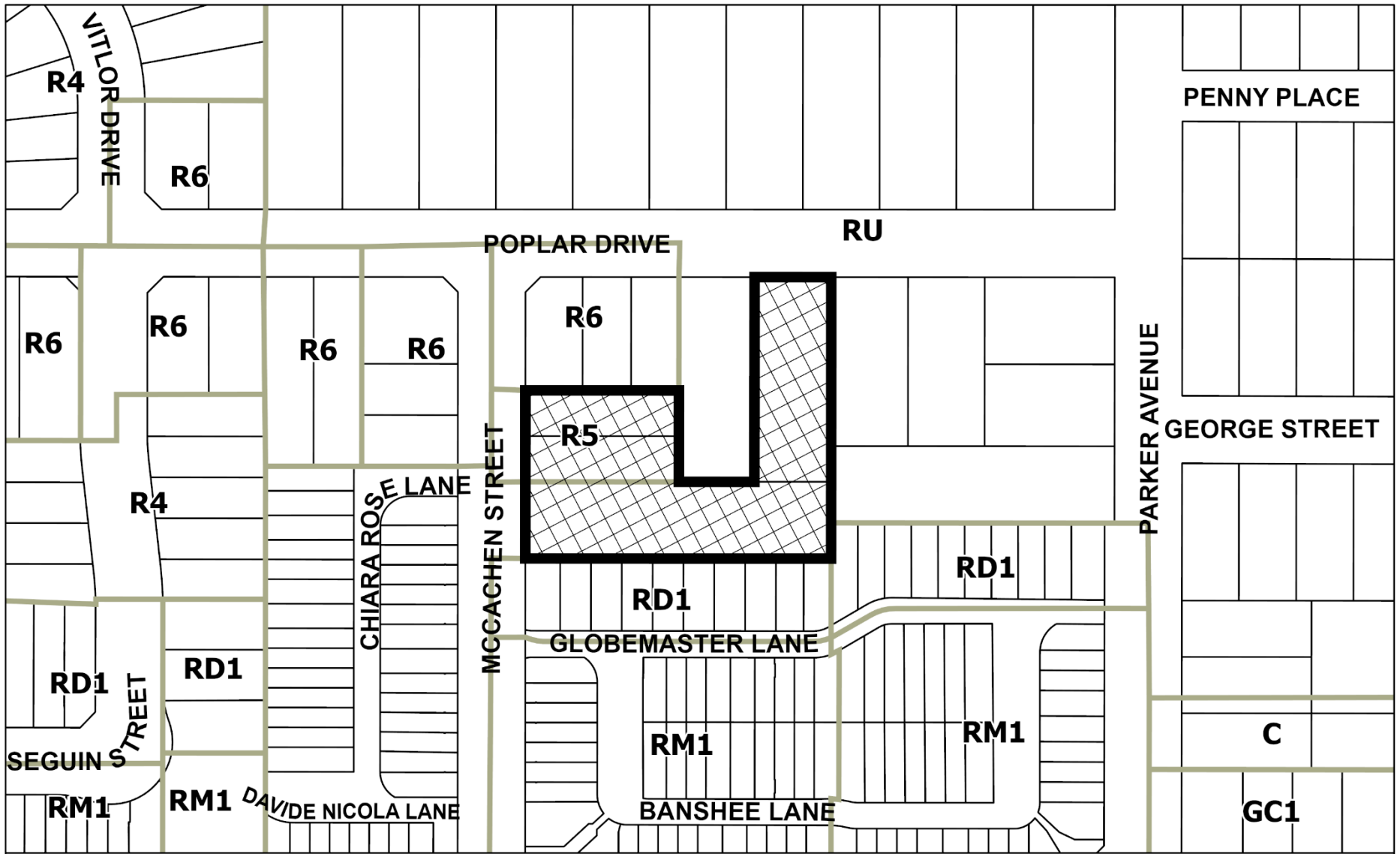

Legend



Subject Lands

7 Poplar Drive and 11, 15, 17 McCachen Street

MM/KG SRPBS.24.055



BLOCK 1 File NO. D02-22009

CITY OF RICHMOND HILL
PLANNING AND BUILDING SERVICES
DEPARTMENT